



Solsbury Hill 🎵

TEM16763A / 3 beds / 2 baths / 1,140 sq. ft. / 16x76

**CLAYTON
RETAILER EXCLUSIVE**

🎵 Alternate Door Location Available

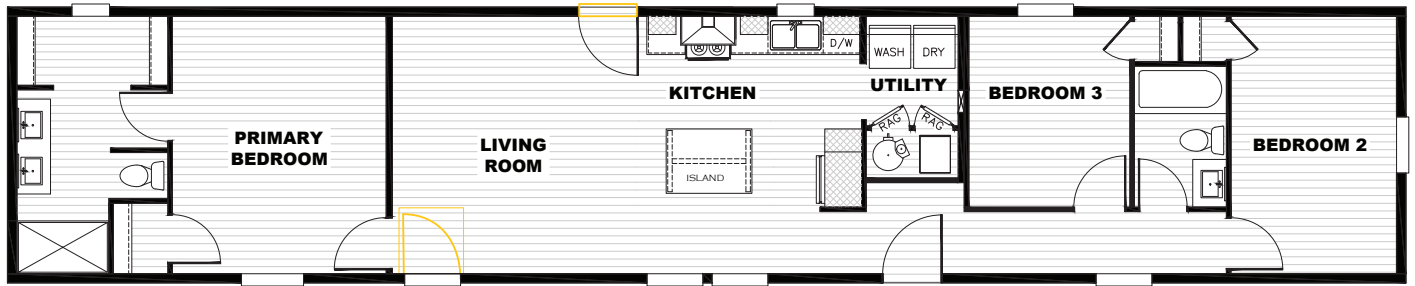

- Finished Drywall Throughout
- Samsung® Stainless Steel Appliances
- ecobee® Smart Thermostat
- Kwikset® Door Hardware Throughout
- Rheem® Hybrid Heat Pump Water Heater
- Carrier® Furnace